



HYDRAULIC ROCK BREAKER

SC6



KEY ASSET  
FOR ALL JOBSITES

DESIGNED FOR 700 KG TO  
1.2 TONNES CARRIERS

COMPACT AND POWERFUL

LANDSCAPING, DEMOLITION,  
TRENCHING, CIVIL ENGINEERING,  
INSIDE AND OUTSIDE:  
VERSATILE AND EFFICIENT

### BENEFITS

- Hydraulic accumulator: no more regular nitrogen controls and recharges on jobsites.
- Tie rod free, lighter tool locking system: less weight, more power and reliability.
- Made in France: superior quality steel and manufacturing excellence.
- Standard soundproofing for urban jobsites
- Easy to install, operate and maintain.

# KEY ASSET FOR ALL JOBSITES

## WEIGHT & DIMENSIONS

### WEIGHT (KG/LB)

|                               |    |     |
|-------------------------------|----|-----|
| BREAKER                       | 51 | 112 |
| + MOUNTED TOOL                | 55 | 121 |
| + MOUNTED ADAPTER PLATE (MAX) | 66 | 146 |

### DIMENSIONS (MM/IN)

|   |       |      |
|---|-------|------|
| A | 1,026 | 40.3 |
| B | 996   | 39.2 |
| C | 595   | 23.4 |
| D | 270   | 10.6 |
| E | 147   | 5.78 |
| F | 171.5 | 6.75 |
| G | 24    | 0.94 |

## OPERATING INFORMATION

|                                      |             |
|--------------------------------------|-------------|
| CARRIER WEIGHT RANGE (MIN-MAX, MT)   | 0.7-1.2     |
| OIL FLOW (MIN-MAX, L/MIN / GPM)      | 12-23 3.2-6 |
| MAXIMUM OPERATING PRESSURE (BAR/PSI) | 110 1,600   |
| MAXIMUM BACK PRESSURE (BAR/PSI)      | 20 290      |
| INPUT POWER (KW)                     | 4.2         |
| STRIKING FREQUENCY (MIN-MAX, BPM)    | 725-1,460   |
| NOISE LEVEL /10M (DBA)               | 115         |
| SOUNDPROOFING                        | standard    |

## OPTIONS

### CPN

|                      |              |
|----------------------|--------------|
| HOSES PROTECTION KIT | 86636685     |
| ADAPTER PLATE        | upon request |
| SPECIAL PAINTING     | upon request |

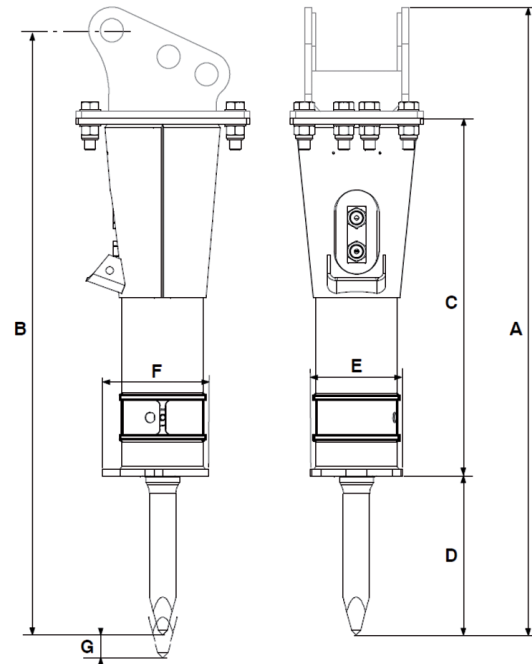

## CONSUMABLES

### CPN

|                         |          |
|-------------------------|----------|
| GREASE CARTRIDGES (X48) | 86799152 |
|-------------------------|----------|

## MAINTENANCE KITS

### CPN

|         |          |
|---------|----------|
| LEVEL 1 | 86685609 |
| LEVEL 3 | 86690567 |

## TOOLS

|                  |          |          |
|------------------|----------|----------|
| DIAMETER (MM/IN) | 37/1.45  | 37/1.45  |
| LENGTH (MM/IN)   | 438/17.2 | 438/17.2 |
| WEIGHT (KG/LB)   | 4/9      | 4/9      |
| CPN              | 86646106 | 86646114 |



Product designs, specifications and/or data in this document are provided for informational purposes only and are not warranties of any kind. Product designs and/or specifications may be changed at any time without notice. The only warranties that apply to sales of products and services are standard written warranties, which will be furnished upon request. Komatsu and other trademarks and service marks used herein are the property of Komatsu Ltd., KMC, or their respective owners or licensees. © 2019 KMC. All rights reserved.

[montabert.com](http://montabert.com) - [montabertusa.com](http://montabertusa.com)





HYDRAULIC ROCK BREAKER

SC8



KEY ASSET  
FOR ALL JOBSITES

DESIGNED FOR 1 TO 1.7  
TONNES CARRIERS

COMPACT AND POWERFUL

LANDSCAPING, DEMOLITION,  
TRENCHING, CIVIL ENGINEERING,  
INSIDE AND OUTSIDE:  
VERSATILE AND EFFICIENT

### BENEFITS

- Hydraulic accumulator: no more regular nitrogen controls and recharges on jobsites.
- Tie rod free, lighter tool locking system: less weight, more power and reliability.
- Made in France: superior quality steel and manufacturing excellence.
- Standard soundproofing for urban jobsites
- Easy to install, operate and maintain.

## HYDRAULIC ROCK BREAKER

KEY ASSET  
FOR ALL JOBSITES

## WEIGHT &amp; DIMENSIONS

## WEIGHT (KG/LB)

|                               |    |     |
|-------------------------------|----|-----|
| BREAKER                       | 57 | 126 |
| + MOUNTED TOOL                | 62 | 137 |
| + MOUNTED ADAPTER PLATE (MAX) | 92 | 203 |

## DIMENSIONS (MM/IN)

|   |       |      |
|---|-------|------|
| A | 1,089 | 42.8 |
| B | 1,049 | 41.2 |
| C | 618   | 24.3 |
| D | 279   | 10.9 |
| E | 159   | 6.25 |
| F | 182.5 | 7.18 |
| G | 25    | 0.98 |

## OPERATING INFORMATION

|                                      |           |
|--------------------------------------|-----------|
| CARRIER WEIGHT RANGE (MIN-MAX, MT)   | 1-1.7     |
| OIL FLOW (MIN-MAX, L/MIN / GPM)      | 15-30 4-8 |
| MAXIMUM OPERATING PRESSURE (BAR/PSI) | 120 1,74  |
| MAXIMUM BACK PRESSURE (BAR/PSI)      | 20 290    |
| INPUT POWER (KW)                     | 6         |
| STRIKING FREQUENCY (MIN-MAX, BPM)    | 800-1,600 |
| NOISE LEVEL /10M (DBA)               | 118       |
| SOUNDPROOFING                        | standard  |

## OPTIONS

## CPN

|                      |              |
|----------------------|--------------|
| HOSES PROTECTION KIT | 86636701     |
| ADAPTER PLATE        | upon request |
| SPECIAL PAINTING     | upon request |

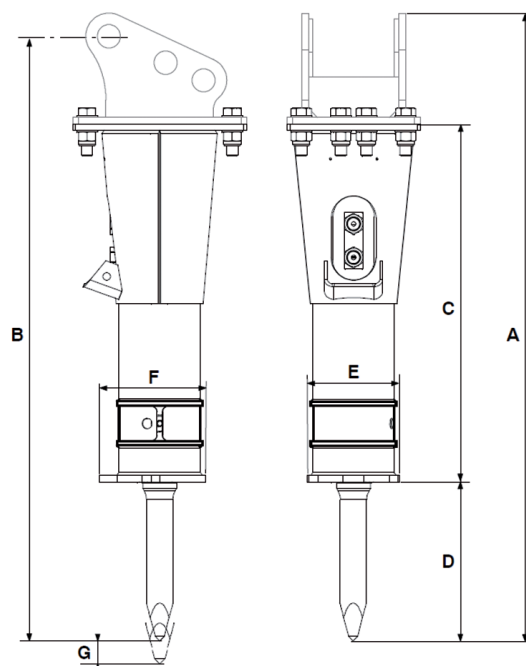

## CONSUMABLES

## CPN

|                         |          |
|-------------------------|----------|
| GREASE CARTRIDGES (X48) | 86799152 |
|-------------------------|----------|

## MAINTENANCE KITS

## CPN

|         |          |
|---------|----------|
| LEVEL 1 | 86638947 |
| LEVEL 2 | 86684552 |
| LEVEL 3 | 86684560 |

## TOOLS

|                  |          |          |          |
|------------------|----------|----------|----------|
| DIAMETER (MM/IN) | 37/1.45  | 37/1.45  | 37/1.45  |
| LENGTH (MM/IN)   | 455/17.9 | 455/17.9 | 455/17.9 |
| WEIGHT (KG/LB)   | 5/11     | 5/11     | 5/11     |
| CPN              | 86631918 | 86631900 | 86638566 |



Product designs, specifications and/or data in this document are provided for informational purposes only and are not warranties of any kind. Product designs and/or specifications may be changed at any time without notice. The only warranties that apply to sales of products and services are standard written warranties, which will be furnished upon request. Komatsu and other trademarks and service marks used herein are the property of Komatsu Ltd., KMC, or their respective owners or licensees. © 2019 KMC. All rights reserved.

montabert.com - montabertusa.com







HYDRAULIC ROCK BREAKER

# SC12



KEY ASSET  
FOR ALL JOBSITES

DESIGNED FOR 1.2 TO 2.2  
TONNES CARRIERS

COMPACT AND POWERFUL

LANDSCAPING, DEMOLITION,  
TRENCHING, CIVIL ENGINEERING,  
INSIDE AND OUTSIDE:  
VERSATILE AND EFFICIENT

## BENEFITS

- Hydraulic accumulator: no more regular nitrogen controls and recharges on jobsites.
- Tie rod free, lighter tool locking system: less weight, more power and reliability.
- Made in France: superior quality steel and manufacturing excellence.
- Standard soundproofing for urban jobsites
- Easy to install, operate and maintain.

## HYDRAULIC ROCK BREAKER

KEY ASSET  
FOR ALL JOBSITES

## WEIGHT &amp; DIMENSIONS

## WEIGHT (KG/LB)

|                               |     |     |
|-------------------------------|-----|-----|
| BREAKER                       | 76  | 168 |
| + MOUNTED TOOL                | 82  | 181 |
| + MOUNTED ADAPTER PLATE (MAX) | 112 | 247 |

## DIMENSIONS (MM/IN)

|   |       |      |
|---|-------|------|
| A | 1,118 | 44   |
| B | 1,078 | 42.4 |
| C | 637   | 25   |
| D | 289   | 11.3 |
| E | 166   | 6.53 |
| F | 190   | 7.48 |
| G | 34    | 1.33 |

## OPERATING INFORMATION

|                                      |               |
|--------------------------------------|---------------|
| CARRIER WEIGHT RANGE (MIN-MAX, MT)   | 1.2-2.2       |
| OIL FLOW (MIN-MAX, L/MIN / GPM)      | 17-35 4.5-9.3 |
| MAXIMUM OPERATING PRESSURE (BAR/PSI) | 120 1,74      |
| MAXIMUM BACK PRESSURE (BAR/PSI)      | 32 465        |
| INPUT POWER (KW)                     | 7             |
| STRIKING FREQUENCY (MIN-MAX, BPM)    | 825-1,700     |
| NOISE LEVEL /10M (DBA)               | 118           |
| SOUNDPROOFING                        | standard      |

## OPTIONS

## CPN

|                      |              |
|----------------------|--------------|
| HOSES PROTECTION KIT | 86636701     |
| ADAPTER PLATE        | upon request |
| SPECIAL PAINTING     | upon request |

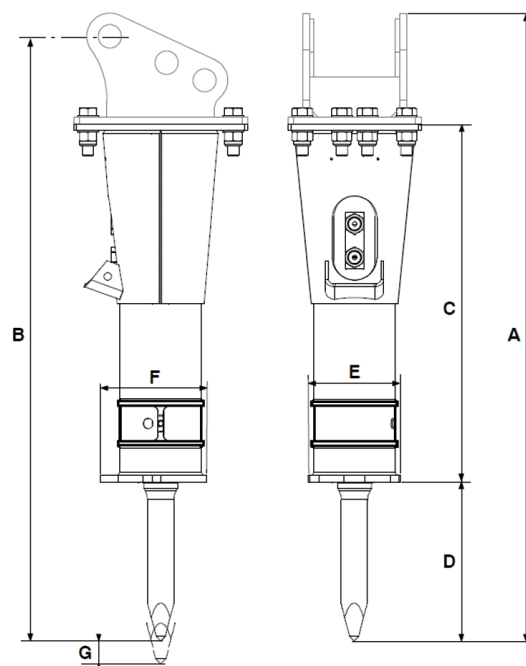

## CONSUMABLES

## CPN

|                         |          |
|-------------------------|----------|
| GREASE CARTRIDGES (X48) | 86799152 |
|-------------------------|----------|

## MAINTENANCE KITS

## CPN

|         |          |
|---------|----------|
| LEVEL 1 | 86638954 |
| LEVEL 2 | 86684594 |
| LEVEL 3 | 86684602 |

## TOOLS

|               |          |          |
|---------------|----------|----------|
| DIAMÈTRE (MM) | 47/1.85  | 47/1.85  |
| LONGUEUR (MM) | 475/18.7 | 475/18.7 |
| POIDS (KG)    | 6/13     | 6/13     |
| CPN           | 86621216 | 86620739 |



Product designs, specifications and/or data in this document are provided for informational purposes only and are not warranties of any kind. Product designs and/or specifications may be changed at any time without notice. The only warranties that apply to sales of products and services are standard written warranties, which will be furnished upon request. Komatsu and other trademarks and service marks used herein are the property of Komatsu Ltd., KMC, or their respective owners or licensees. © 2019 KMC. All rights reserved.

montabert.com - montabertusa.com





HYDRAULIC ROCK BREAKER  
**SC16**



KEY ASSET  
FOR ALL JOBSITES

DESIGNED FOR 1.5 TO 3.7  
TONNES CARRIERS

COMPACT AND POWERFUL

LANDSCAPING, DEMOLITION,  
TRENCHING, CIVIL ENGINEERING,  
INSIDE AND OUTSIDE:  
VERSATILE AND EFFICIENT

### BENEFITS

- Hydraulic accumulator: no more regular nitrogen controls and recharges on jobsites.
- Tie rod free, lighter tool locking system: less weight, more power and reliability.
- Made in France: superior quality steel and manufacturing excellence.
- Standard soundproofing for urban jobsites
- Easy to install, operate and maintain.

## HYDRAULIC ROCK BREAKER

KEY ASSET  
FOR ALL JOBSITES

## WEIGHT &amp; DIMENSIONS

## WEIGHT (KG/LB)

|                               |     |     |
|-------------------------------|-----|-----|
| BREAKER                       | 85  | 187 |
| + MOUNTED TOOL                | 95  | 209 |
| + MOUNTED ADAPTER PLATE (MAX) | 153 | 337 |

## DIMENSIONS (MM/IN)

|   |       |      |
|---|-------|------|
| A | 1,216 | 47.8 |
| B | 1,166 | 45.9 |
| C | 701   | 27.5 |
| D | 335   | 13.1 |
| E | 186   | 7.32 |
| F | 205   | 8.07 |
| G | 34    | 1.33 |

## OPERATING INFORMATION

|                                      |                |
|--------------------------------------|----------------|
| CARRIER WEIGHT RANGE (MIN-MAX, MT)   | 1.5-3.7        |
| OIL FLOW (MIN-MAX, L/MIN / GPM)      | 25-50 6.6-13.2 |
| MAXIMUM OPERATING PRESSURE (BAR/PSI) | 120 1,74       |
| MAXIMUM BACK PRESSURE (BAR/PSI)      | 32 465         |
| INPUT POWER (KW)                     | 10             |
| STRIKING FREQUENCY (MIN-MAX, BPM)    | 770-1,550      |
| NOISE LEVEL /10M (DBA)               | 119            |
| SOUNDPROOFING                        | standard       |

## OPTIONS

## CPN

|                      |              |
|----------------------|--------------|
| HOSES PROTECTION KIT | 86636719     |
| ADAPTER PLATE        | upon request |
| SPECIAL PAINTING     | upon request |

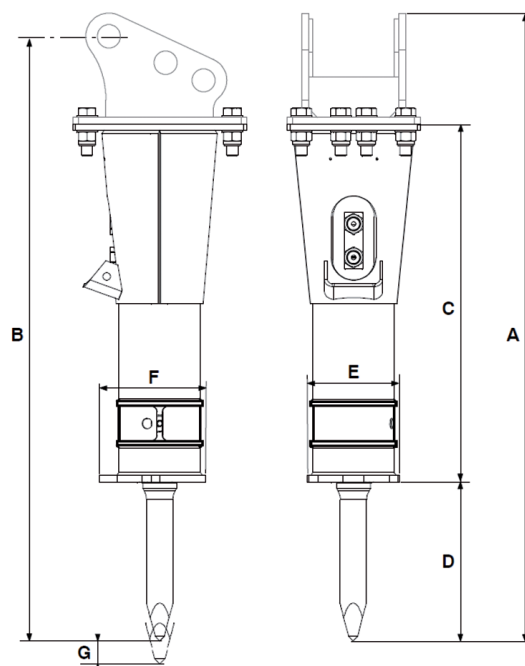

## CONSUMABLES

## CPN

|                         |          |
|-------------------------|----------|
| GREASE CARTRIDGES (X48) | 86799152 |
|-------------------------|----------|

## MAINTENANCE KITS

## CPN

|         |          |
|---------|----------|
| LEVEL 1 | 86638962 |
| LEVEL 2 | 86684636 |
| LEVEL 3 | 86684644 |

## TOOLS

|                  |          |          |
|------------------|----------|----------|
| DIAMETER (MM/IN) | 55/2.16  | 55/2.16  |
| LENGTH (MM/IN)   | 550/21.6 | 550/21.6 |
| WEIGHT (KG/LB)   | 10/22    | 10/22    |
| CPN              | 86625688 | 86625670 |



Product designs, specifications and/or data in this document are provided for informational purposes only and are not warranties of any kind. Product designs and/or specifications may be changed at any time without notice. The only warranties that apply to sales of products and services are standard written warranties, which will be furnished upon request. Komatsu and other trademarks and service marks used herein are the property of Komatsu Ltd., KMC, or their respective owners or licensees. © 2019 KMC. All rights reserved.

montabert.com - montabertusa.com







HYDRAULIC ROCK BREAKER  
**SC22**



KEY ASSET  
FOR ALL JOBSITES

DESIGNED FOR 2.5 TO 5.3  
TONNES CARRIERS

COMPACT AND POWERFUL

LANDSCAPING, DEMOLITION,  
TRENCHING, CIVIL ENGINEERING,  
INSIDE AND OUTSIDE:  
VERSATILE AND EFFICIENT

### BENEFITS

- Hydraulic accumulator: no more regular nitrogen controls and recharges on jobsites.
- Tie rod free, lighter tool locking system: less weight, more power and reliability.
- Made in France: superior quality steel and manufacturing excellence.
- Standard soundproofing for urban jobsites
- Easy to install, operate and maintain.

## HYDRAULIC ROCK BREAKER

KEY ASSET  
FOR ALL JOBSITES

## WEIGHT &amp; DIMENSIONS

## WEIGHT (KG/LB)

|                               |     |     |
|-------------------------------|-----|-----|
| BREAKER                       | 134 | 295 |
| + MOUNTED TOOL                | 150 | 330 |
| + MOUNTED ADAPTER PLATE (MAX) | 230 | 507 |

## DIMENSIONS (MM/IN)

|   |       |      |
|---|-------|------|
| A | 1,412 | 55.5 |
| B | 1,357 | 53.4 |
| C | 812   | 31.9 |
| D | 370   | 14.5 |
| E | 214   | 8.42 |
| F | 240   | 9.44 |
| G | 45    | 1.77 |

## OPERATING INFORMATION

|                                      |              |
|--------------------------------------|--------------|
| CARRIER WEIGHT RANGE (MIN-MAX, MT)   | 2,5-5,3      |
| OIL FLOW (MIN-MAX, L/MIN / GPM)      | 30-65 8-17.2 |
| MAXIMUM OPERATING PRESSURE (BAR/PSI) | 120 1,74     |
| MAXIMUM BACK PRESSURE (BAR/PSI)      | 30 435       |
| INPUT POWER (KW)                     | 13           |
| STRIKING FREQUENCY (MIN-MAX, BPM)    | 600-1,360    |
| NOISE LEVEL /10M (DBA)               | 118          |
| SOUNDPROOFING                        | standard     |

## OPTIONS

## CPN

|                      |              |
|----------------------|--------------|
| HOSES PROTECTION KIT | 86636727     |
| ADAPTER PLATE        | upon request |
| SPECIAL PAINTING     | upon request |

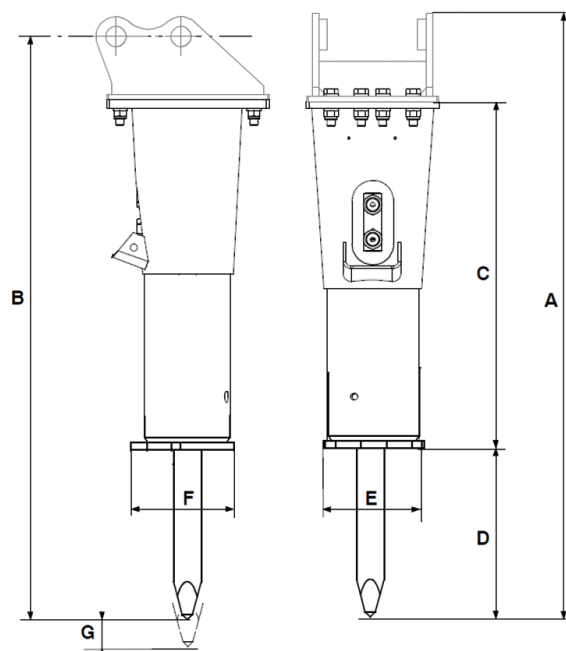

## CONSUMABLES

## CPN

GREASE CARTRIDGES (X48)

86799152

## MAINTENANCE KITS

## CPN

LEVEL 1

86779709

LEVEL 2

86771706

LEVEL 3

86779717

## TOOLS

|                  |          |          |
|------------------|----------|----------|
| DIAMETER (MM/IN) | 65/2.55  | 65/2.55  |
| LENGTH (MM/IN)   | 618/24.3 | 618/24.3 |
| WEIGHT (KG/LB)   | 16/35    | 16/35    |
| CPN              | 86636370 | 86636362 |



Product designs, specifications and/or data in this document are provided for informational purposes only and are not warranties of any kind. Product designs and/or specifications may be changed at any time without notice. The only warranties that apply to sales of products and services are standard written warranties, which will be furnished upon request. Komatsu and other trademarks and service marks used herein are the property of Komatsu Ltd., KMC, or their respective owners or licensees. © 2019 KMC. All rights reserved.

montabert.com - montabertusa.com





HYDRAULIC ROCK BREAKER  
**SC28**



KEY ASSET  
FOR ALL JOBSITES

DESIGNED FOR 3 TO 7.5  
TONNES CARRIERS

COMPACT AND POWERFUL

LANDSCAPING, DEMOLITION,  
TRENCHING, CIVIL ENGINEERING,  
INSIDE AND OUTSIDE:  
VERSATILE AND EFFICIENT

**BENEFITS**

- Hydraulic accumulator: no more regular nitrogen controls and recharges on jobsites.
- Tie rod free, lighter tool locking system: less weight, more power and reliability.
- Made in France: superior quality steel and manufacturing excellence.
- Standard soundproofing for urban jobsites
- Easy to install, operate and maintain.

## HYDRAULIC ROCK BREAKER

KEY ASSET  
FOR ALL JOBSITES

## WEIGHT &amp; DIMENSIONS

## WEIGHT (KG/LB)

|                               |     |     |
|-------------------------------|-----|-----|
| BREAKER                       | 173 | 381 |
| + MOUNTED TOOL                | 193 | 425 |
| + MOUNTED ADAPTER PLATE (MAX) | 273 | 602 |

## DIMENSIONS (MM/IN)

|   |       |      |
|---|-------|------|
| A | 1,493 | 58.7 |
| B | 1,438 | 56.6 |
| C | 863   | 33.9 |
| D | 400   | 15.7 |
| E | 223   | 8.77 |
| F | 250   | 9.84 |
| G | 46    | 1.81 |

## OPERATING INFORMATION

|                                      |               |
|--------------------------------------|---------------|
| CARRIER WEIGHT RANGE (MIN-MAX, MT)   | 3-7.5         |
| OIL FLOW (MIN-MAX, L/MIN / GPM)      | 40-75 10.5-20 |
| MAXIMUM OPERATING PRESSURE (BAR/PSI) | 120 1,74      |
| MAXIMUM BACK PRESSURE (BAR/PSI)      | 30 435        |
| INPUT POWER (KW)                     | 13            |
| STRIKING FREQUENCY (MIN-MAX, BPM)    | 630-1,420     |
| NOISE LEVEL /10M (DBA)               | 122           |
| SOUNDPROOFING                        | standard      |

## OPTIONS

## CPN

|                      |              |
|----------------------|--------------|
| HOSES PROTECTION KIT | 86636735     |
| ADAPTER PLATE        | upon request |
| SPECIAL PAINTING     | upon request |

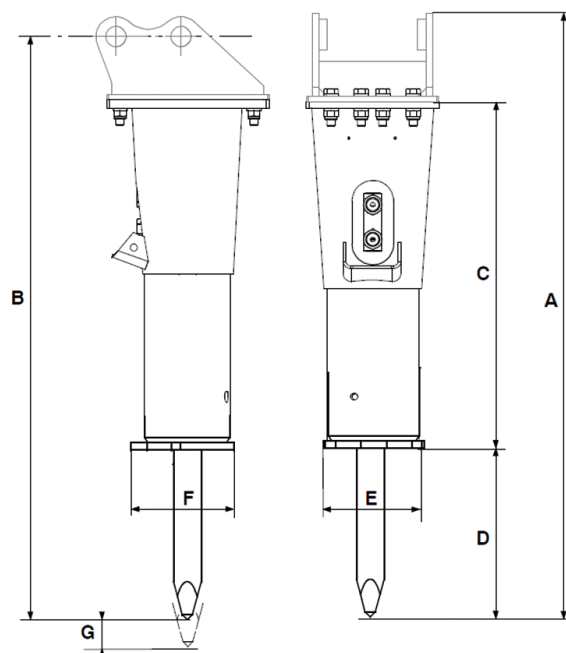

## CONSUMABLES

## CPN

GREASE CARTRIDGES (X48)

86799152

## MAINTENANCE KITS

## CPN

LEVEL 1

86779741

LEVEL 3

86771672

## TOOLS

|                  |          |          |
|------------------|----------|----------|
| DIAMETER (MM/IN) | 72/2.83  | 72/2.83  |
| LENGTH (MM/IN)   | 662/26   | 662/26   |
| WEIGHT (KG/LB)   | 20/44    | 20/44    |
| CPN              | 86636396 | 86636388 |



Product designs, specifications and/or data in this document are provided for informational purposes only and are not warranties of any kind. Product designs and/or specifications may be changed at any time without notice. The only warranties that apply to sales of products and services are standard written warranties, which will be furnished upon request. Komatsu and other trademarks and service marks used herein are the property of Komatsu Ltd., KMC, or their respective owners or licensees. © 2019 KMC. All rights reserved.

montabert.com - montabertusa.com





HYDRAULIC ROCK BREAKER  
**SC36**



KEY ASSET  
FOR ALL JOBSITES

DESIGNED FOR 4 TO 10  
TONNES CARRIERS

COMPACT AND POWERFUL

LANDSCAPING, DEMOLITION,  
TRENCHING, CIVIL ENGINEERING,  
INSIDE AND OUTSIDE:  
VERSATILE AND EFFICIENT

**BENEFITS**

- Hydraulic accumulator: no more regular nitrogen controls and recharges on jobsites.
- Tie rod free, lighter tool locking system: less weight, more power and reliability.
- Made in France: superior quality steel and manufacturing excellence.
- Standard soundproofing for urban jobsites
- Easy to install, operate and maintain.



## HYDRAULIC ROCK BREAKER

KEY ASSET  
FOR ALL JOBSITES

## WEIGHT &amp; DIMENSIONS

## WEIGHT (KG/LB)

|                               |     |     |
|-------------------------------|-----|-----|
| BREAKER                       | 279 | 615 |
| + MOUNTED TOOL                | 304 | 670 |
| + MOUNTED ADAPTER PLATE (MAX) | 388 | 855 |

## DIMENSIONS (MM/IN)

|   |        |       |
|---|--------|-------|
| A | 1711.5 | 67.3  |
| B | 1656.5 | 65.2  |
| C | 979.5  | 38.5  |
| D | 400    | 15.7  |
| E | 240    | 9.44  |
| F | 270    | 10.62 |
| G | 47.5   | 1.87  |

## OPERATING INFORMATION

|                                      |                  |
|--------------------------------------|------------------|
| CARRIER WEIGHT RANGE (MIN-MAX, MT)   | 4-10             |
| OIL FLOW (MIN-MAX, L/MIN / GPM)      | 55-100 14.5-26.5 |
| MAXIMUM OPERATING PRESSURE (BAR/PSI) | 125 1,815        |
| MAXIMUM BACK PRESSURE (BAR/PSI)      | 20 290           |
| INPUT POWER (KW)                     | 20.8             |
| STRIKING FREQUENCY (MIN-MAX, BPM)    | 700-1,540        |
| NOISE LEVEL /10M (DBA)               | 121              |
| SOUNDPROOFING                        | standard         |

## OPTIONS

## CPN

|                      |              |
|----------------------|--------------|
| HOSES PROTECTION KIT | 86640703     |
| ADAPTER PLATE        | upon request |
| SPECIAL PAINTING     | upon request |

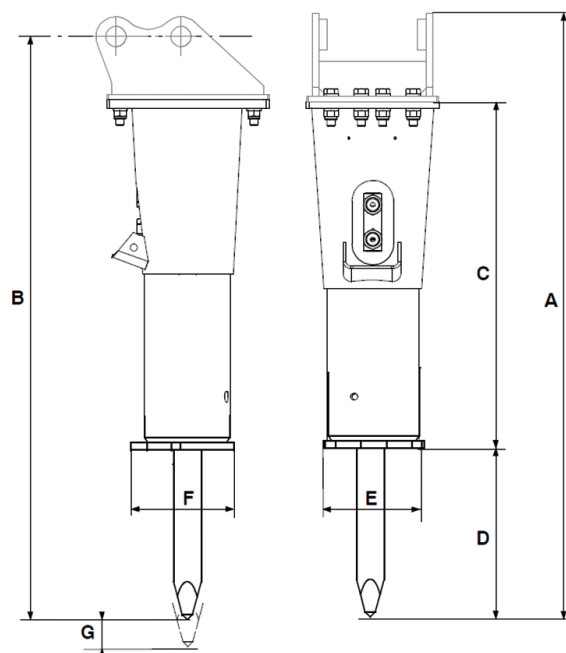

## CONSUMABLES

## CPN

|                         |          |
|-------------------------|----------|
| GREASE CARTRIDGES (X48) | 86799152 |
|-------------------------|----------|

## MAINTENANCE KITS

## CPN

|         |          |
|---------|----------|
| LEVEL 1 | 86639960 |
| LEVEL 2 | 86771581 |
| LEVEL 3 | 86771599 |

## TOOLS

|                  |          |          |          |
|------------------|----------|----------|----------|
| DIAMETER (MM/IN) | 76/2.99  | 76/2.99  | 76/2.99  |
| LENGTH (MM/IN)   | 709/27.9 | 709/27.9 | 709/27.9 |
| WEIGHT (KG/LB)   | 25/55    | 25/55    | 25/55    |
| CPN              | 86639226 | 86639218 | 86641438 |



Product designs, specifications and/or data in this document are provided for informational purposes only and are not warranties of any kind. Product designs and/or specifications may be changed at any time without notice. The only warranties that apply to sales of products and services are standard written warranties, which will be furnished upon request. Komatsu and other trademarks and service marks used herein are the property of Komatsu Ltd., KMC, or their respective owners or licensees. © 2019 KMC. All rights reserved.

montabert.com - montabertusa.com





HYDRAULIC ROCK BREAKER

# SC42



KEY ASSET  
FOR ALL JOBSITES

DESIGNED FOR 5 TO 12  
TONNES CARRIERS

COMPACT AND POWERFUL

LANDSCAPING, DEMOLITION,  
TRENCHING, CIVIL ENGINEERING,  
INSIDE AND OUTSIDE:  
VERSATILE AND EFFICIENT

## BENEFITS

- Hydraulic accumulator: no more regular nitrogen controls and recharges on jobsites.
- Tie rod free, lighter tool locking system: less weight, more power and reliability.
- Made in France: superior quality steel and manufacturing excellence.
- Standard soundproofing for urban jobsites
- Easy to install, operate and maintain.

## HYDRAULIC ROCK BREAKER

KEY ASSET  
FOR ALL JOBSITES

## WEIGHT &amp; DIMENSIONS

## WEIGHT (KG/LB)

|                               |     |       |
|-------------------------------|-----|-------|
| BREAKER                       | 345 | 761   |
| + MOUNTED TOOL                | 379 | 836   |
| + MOUNTED ADAPTER PLATE (MAX) | 465 | 1,021 |

## DIMENSIONS (MM/IN)

|   |       |      |
|---|-------|------|
| A | 1,831 | 72   |
| B | 1,776 | 70   |
| C | 1,06  | 41.7 |
| D | 439   | 17.2 |
| E | 270   | 10.6 |
| F | 295   | 11.6 |
| G | 50    | 1.96 |

## OPERATING INFORMATION

|                                      |                |
|--------------------------------------|----------------|
| CARRIER WEIGHT RANGE (MIN-MAX, MT)   | 5-12           |
| OIL FLOW (MIN-MAX, L/MIN / GPM)      | 70-120 18.5-32 |
| MAXIMUM OPERATING PRESSURE (BAR/PSI) | 125 1,815      |
| MAXIMUM BACK PRESSURE (BAR/PSI)      | 20 290         |
| INPUT POWER (KW)                     | 25             |
| STRIKING FREQUENCY (MIN-MAX, BPM)    | 700-1,440      |
| NOISE LEVEL /10M (DBA)               | 120            |
| SOUNDPROOFING                        | standard       |

## OPTIONS

## CPN

|                  |              |
|------------------|--------------|
| ADAPTER PLATE    | upon request |
| SPECIAL PAINTING | upon request |

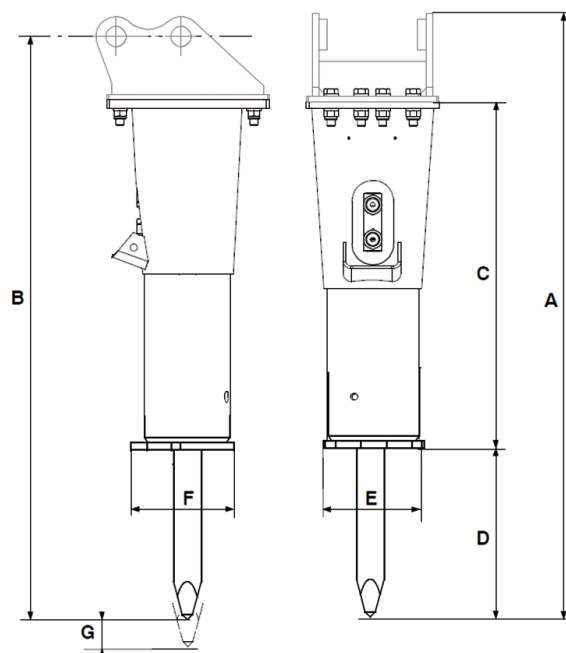

## CONSUMABLES

## CPN

GREASE CARTRIDGES (X48)

86799152

## MAINTENANCE KITS

## CPN

LEVEL 1

86675857

## TOOLS

|                  |          |          |          |
|------------------|----------|----------|----------|
| DIAMETER (MM/IN) | 84/33    | 84/33    | 84/33    |
| LENGTH (MM/IN)   | 785/31   | 785/31   | 785/31   |
| WEIGHT (KG/LB)   | 34/75    | 34/75    | 34/75    |
| CPN              | 86665338 | 86665361 | 86685047 |



Product designs, specifications and/or data in this document are provided for informational purposes only and are not warranties of any kind. Product designs and/or specifications may be changed at any time without notice. The only warranties that apply to sales of products and services are standard written warranties, which will be furnished upon request. Komatsu and other trademarks and service marks used herein are the property of Komatsu Ltd., KMC, or their respective owners or licensees. © 2019 KMC. All rights reserved.

[montabert.com](http://montabert.com) - [montabertusa.com](http://montabertusa.com)
